



INSTRUCTION BULLETIN

No. 9007105
Machine: See Below
Published: 10-2009
Rev. 00

NOTE: DO NOT DISCARD the Parts List from the Instruction Bulletin. Place the Parts List in the appropriate place in the machine manual for future reference. Retaining the Parts List will make it easier to reorder individual parts and will save the cost of ordering an entire kit.

NOTE: Numbers in parenthesis () are reference numbers for parts listed in Bill of Materials.

Installation instructions for **kit number 9007088**

SYNOPSIS:

This kit contains the parts needed to replace the sheave assembly on M20, M30, T20, S30, 8200/8210, 7400, and 6600/6650 machines equipped with GM 1.6L Gas or LP engines. Please follow step-by-step instructions.

SPECIAL TOOLS / CONSIDERATIONS: NONE

(Estimated time to complete: 3 hours)

PREPARATION:

1. Park the machine on a clean level surface, turn off the machine, remove the key, and set the parking brake.

FOR SAFETY: Before leaving or servicing machine, stop on level surface, turn off machine, and remove key.

2. Open and / or remove shrouds / covers necessary to access the engine.

INSTALLATION:

1. Remove the fan shroud / belt guard from the machine. Set the fan shroud / belt guard and all mounting hardware aside.
2. Drain the antifreeze from the coolant system. Dispose of the drained antifreeze.

NOTE: Antifreeze is an environmentally hazardous chemical. Dispose of antifreeze in an environmentally safe manner according to local waste disposal regulations.

3. Remove the radiator from the machine. Set the radiator and all mounting hardware aside.

4. Remove the cooling fan assembly and spacer from the engine. Set the fan assembly, spacer, and all mounting hardware aside. Refer to Fig. 1.
5. Remove the engine belt from the machine. Set the engine belt aside. Refer to Fig. 1.
6. Remove the sheave and fan hub pulley from the machine. Discard the sheave, fan hub pulley, and all mounting hardware. Refer to Fig. 1.

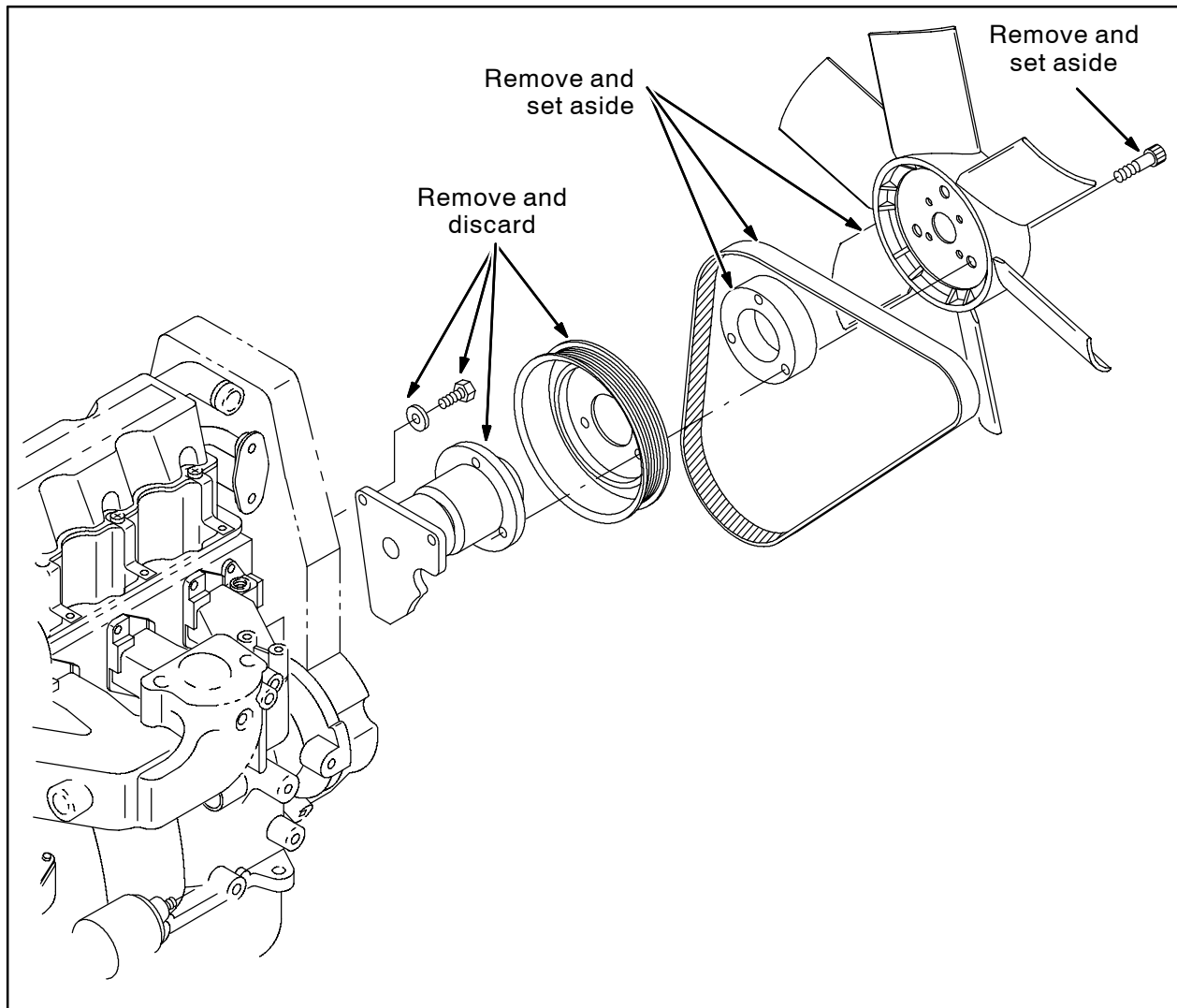

FIG. 1

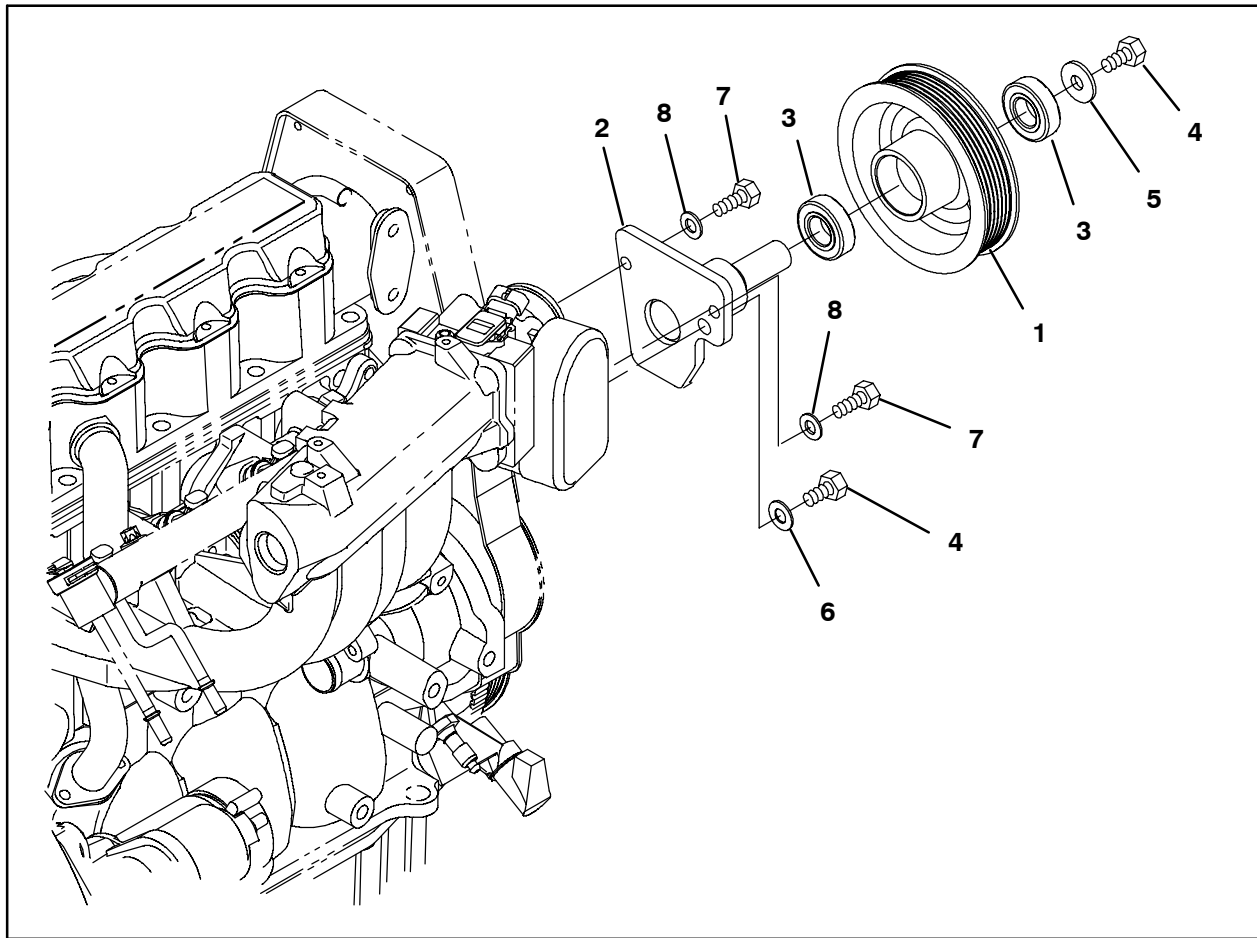

FIG. 2

7. Use a two hex screws (4), one hex screw (7), two flat washers (8), and one flat washer (6) to install the fan hub plate (2) onto the engine. Refer to Fig. 2.
 8. Press both ball bearings (3) into the sheave (1). Refer to Fig. 2.
 9. Slide the sheave assembly onto the fan hub plate (2). Refer to Fig. 2.
 10. Use a hex screw (4) and a flat washer (5) to secure the sheave assembly onto the fan hub plate (2). Refer to Fig. 2.
 11. Position the engine belt onto the sheave assembly, alternator, and harmonic balancer.
 12. Reinstall the cooling fan assembly and spacer onto the machine.
 13. Tighten the engine belt to the appropriate tension. Refer to the Maintenance section of the Operators manual for the correct tension.
 14. Check the engine belt alignment. If necessary, make necessary adjustments to properly align the belt.
 15. Reinstall the fan shroud / belt guard onto the radiator.
 16. Reinstall the radiator onto the machine.
 17. Refill the engine cooling system with the appropriate amount of fresh antifreeze. Refer to the Specifications section of the Operators Manual for the required amount.
- NOTE: Be sure all air is purged from the cooling system before operating the machine.*
18. Start and test the machine. Observe the coolant system for leaks.

Bill of Materials for Sheave Assy, Kit, Repair - 9007088

	Ref.	Tennant Part No.	Description	Qty.
▽		9007088	SHEAVE ASSY, KIT, REPAIR	1
▲	1	1055425	SHEAVE, MACH [GM1.6L]	1
▲	2	1055381	PLATE WLDT, FAN, HUB [GM 1.6L]	1
▲	3	1055377	BEARING, BALL, 20MM B 42MM D 12MM W	2
▲	4	21195	SCREW, HEX, .38-16 X 0.75, G5	2
▲	5	1014563	WASHER, FLAT, 0.40B 1.12D .12, SS	1
▲	6	32485	WASHER, FLAT, 0.38, SAE	1
▲	7	16931	SCREW, HEX, M8 X 1.25 X 20, 8.8	2
▲	8	39349	WASHER, FLAT, 0.31, SAE	2

TENNANT COMPANY
P. O. Box 1452
Minneapolis, MN 55440-1452